

MOTORIZED ER COLLET CHUCK PUNCH FORMER ARC020-PPM

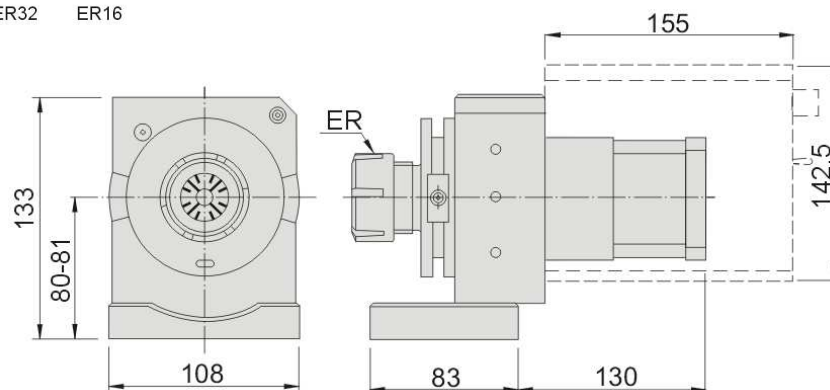

Dimensions (mm)			
Part Number	Supplied with ER collets \varnothing	Variable speed rpm	Weight Kg
6002/02/16/...V	2, 3, 4, 6, 8	50 à 300	8,2
6002/02/32/...V	4, 8, 12, 16, 20	50 à 300	9,2
6002/02/40/...V	6, 10, 16, 20, 25	50 à 300	10,2

Uses : On surface grinding machine ARC020-PPM is suitable for processing of punches.

Features : Grinded hardened tool steel

- Voltage : 110 Vac / 60 Hz or 230 Vac / 50 hz
- Other versions : 3 jaws chuck version, hand operated version