

**FLAT POT MAGNET NEODYMIUM, WITH EXTERNAL THEAD,
GALVANIZED – VND33 -**

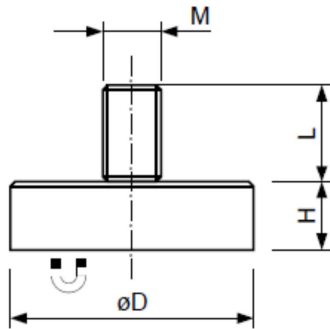

| Part Number | Dimensions (mm) | | | | Force N | Poids g |
|--------------|-----------------|-----|----|----|------------|------------|
| | øD | H | L | M | | |
| 2091/36/6 | 6 | 4,5 | 7 | M3 | 5 | 1,3 |
| 2091/36/8 | 8 | 4,5 | 8 | M4 | 13 | 2,3 |
| 2091/36/10-1 | 10 | 4,5 | 7 | M3 | 25 | 2,5 |
| 2091/36/10-2 | 10 | 4,5 | 8 | M4 | 25 | 3 |
| 2091/36/13 | 13 | 4,5 | 8 | M5 | 60 | 5 |
| 2091/36/16 | 16 | 4,5 | 8 | M6 | 95 | 8 |
| 2091/36/20 | 20 | 6 | 10 | M6 | 140 | 15 |
| 2091/36/25 | 25 | 7 | 10 | M6 | 200 | 27 |
| 2091/36/32 | 32 | 7 | 10 | M6 | 350 | 42 |
| 2091/36/40 | 40 | 8 | 12 | M8 | 670 | 80 |



Maximum use temperature : 80°C

* The forces have been determined at room temperature on a plate in polished steel (S235JR according to DIN 10 025) with a thickness of 10 mm