

FLAT POT MAGNET HARD FERRITE WITH EXTERNAL THREAD, GALVANIZED – VF08

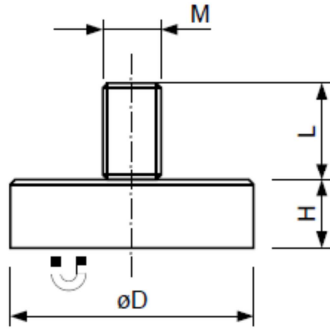

Part Number	Dimensions (mm)				Force N	Weight g
	øD	H	L	M		
2091/14/10	10	4,5	7	M3	4	2
2091/14/13	13	4,5	7	M3	10	3
2091/14/16/1	16	4,5	7	M3	18	5
2091/14/16/2	16	4,5	6	M4	18	5
2091/14/20/1	20	6	7	M3	30	10
2091/14/20/2	20	6	30	M6	30	15
2091/14/25/1	25	7	8	M4	40	19
2091/14/25/2	25	7	15	M5	40	20
2091/14/25/3	25	7	20	M6	40	22
2091/14/32/1	32	7	8	M4	80	30
2091/14/32/3	32	7	12	M6	80	31
2091/14/32/4	32	7	10	M8	80	32
2091/14/47	47	9	8,0	M6	180	85
2091/14/57/2	57	10,5	8	M6	280	146
2091/14/63	63	14	15	M6	350	233



Maximum use temperature : 200°C

* The forces have been determined at room temperature on a plate in polished steel (S235JR according to DIN 10 025) with a thickness of 10 mm