

FLAT POT MAGNET HARD FERRITE, WITH BORE AND COUNTER BORE, GALVANIZED - VF01 -

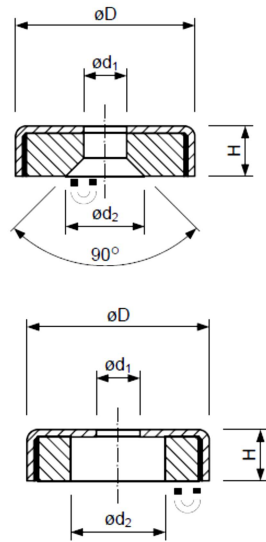

Dimensions en mm							
Part Number	øD	H	ød1	ød2	90° counterbore	Force N	Weight g
2091/11/16	16	4,5	3,5	6,5	yes	14	4
2091/11/20*	20	6	4,1	9,4	yes	27	9
2091/11/25*	25	7	5,5	11,5	yes	36	17
2091/11/32*	32	7	5,5	11,5	yes	72	27
2091/11/40*	40	8	5,5	11,5	yes	90	52
2091/11/50*	50	10	8,5	22	no	180	85
2091/11/57	57	11	6,5	24	no	230	130
2091/11/63*	63	14	6,5	24	no	290	197
2091/11/80B	80	10	6,4	32	no	450	235
2091/11/80	80	18	6,5	11,5	no	540	458
2091/11/83	83	18	10,5	32	no	600	444
2091/11/100	100	22	10,5	34	no	680	815

* Also available with stainless steel housing.



Maximum use temperature : 200°C

* The forces have been determined at room temperature on a plate in polished steel (S235JR according to DIN 10 025) with a thickness of 10 mm