

FLAT POT MAGNET HARD FERRITE, WITH BORE AND COUNTER BORE, STAINLESS STEEL - VF01AI-

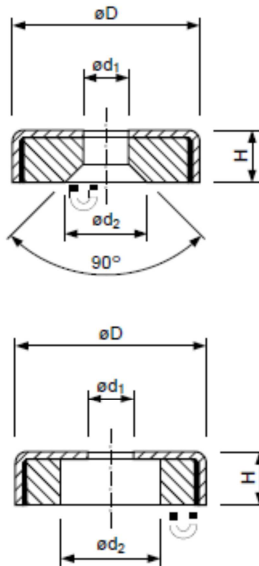

Dimensions (mm)							
Part Number	øD	H	ød1	ød2	90° counterbore	Force N	Weight g
2091/11/20AI	20	6	4,1	9,4	yes	22	9
2091/11/25AI	25	7	5,5	11,5	yes	29	17
2091/11/32AI	32	7	5,5	11,5	yes	58	27
2091/11/40AI	40	8	5,5	11,5	yes	72	52
2091/11/50AI	50	10	8,5	22	no	145	85
2091/11/63AI	63	14	6,5	24	no	230	195



Maximum use temperature : 220°C

** The forces have been determined at room temperature on a plate in polished steel (S235JR according to DIN 10 025) with a thickness of 10 mm*